

Type HWN

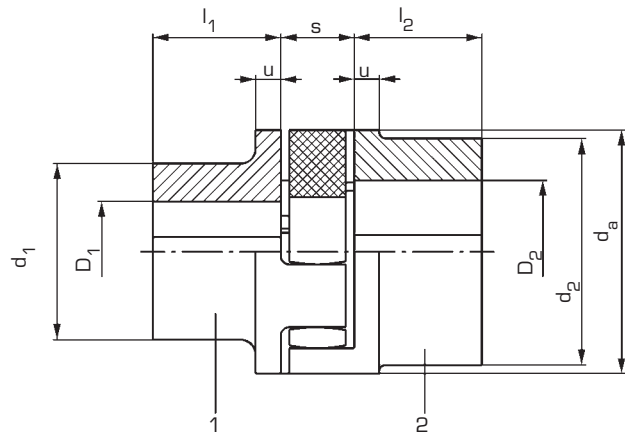
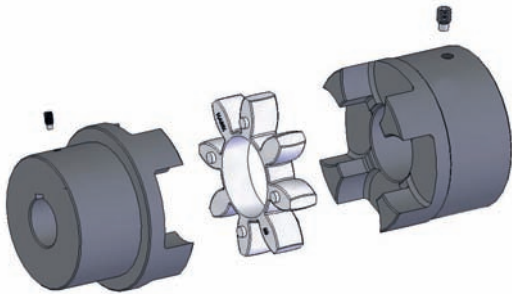

Size	Part 1				Part 2				da	u	s
	Pre. mm	max. mm	mm	mm	Pre. mm	max. mm	mm	mm			
19	-	19	32	25	17	24	39,5	25	40	5	16
24	-	24	40	30	22	28	48	30	55	6	18
28	-	28	48	35	26	38	64,5	35	65	7	20
38	10	38	66	45	36	45	78	45	80	8	24
42	12	42	75	50	40	55	94	50	95	10	26
48	13	48	85	56	46	60	104	56	105	11	28
55	18	55	98	65	53	70	118	65	120	13	30
65	20	65	115	75	63	75	134	75	135	14	35
75	28	75	135	85	73	90	158	85	160	16	40
90	38	90	160	100	88	100	180	100	200	19	45

Size	Weight / kg		Moments of inertia kgm ²	
	Part 1	Part 2	Part 1	Part 2
19	0,16	0,21	0,00003	0,00005
24	0,40	0,40	0,00011	0,00015
28	0,52	0,76	0,00024	0,00049
38	1,1	1,4	0,00087	0,0013
42	1,7	2,3	0,0018	0,0031
48	2,8	3,1	0,0031	0,0052
55	3,7	4,6	0,062	0,010
65	5,7	7,0	0,013	0,019
75	8,8	11	0,027	0,041
90	15	15	0,068	0,090

- > Drill holes H7 with keyway in accordance with DIN 6885/1; tolerance zone JS9 and set screws on the keyway; weight and moments of inertia valid for medium bore diameters; coupling half materials: EN-GJL-250 (GG-25) in accordance with DIN EN 1561